

SIGN TYPE E - 1No. (illuminated)

Individual 3mm thick brushed aluminium letters fixed to wall with stand off fixings and backlit with halo lighting



SIGN TYPE A - 2No. (non-illuminated)

Individual 3D acrylic letters (40mm deep) fixed to fascia panel

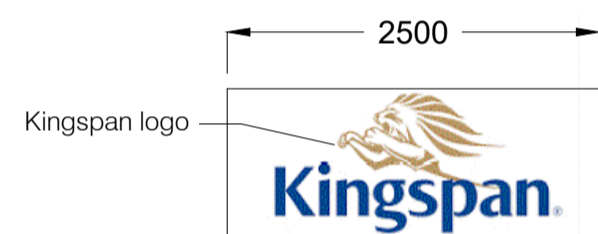

SIGN TYPE B - 2No. (non-illuminated)

Logo printed on aluminium composite board fixed to fascia panel



SIGN TYPE C - 2No. (non-illuminated)

Individual 3D acrylic letters (30mm deep) fixed to fascia panel

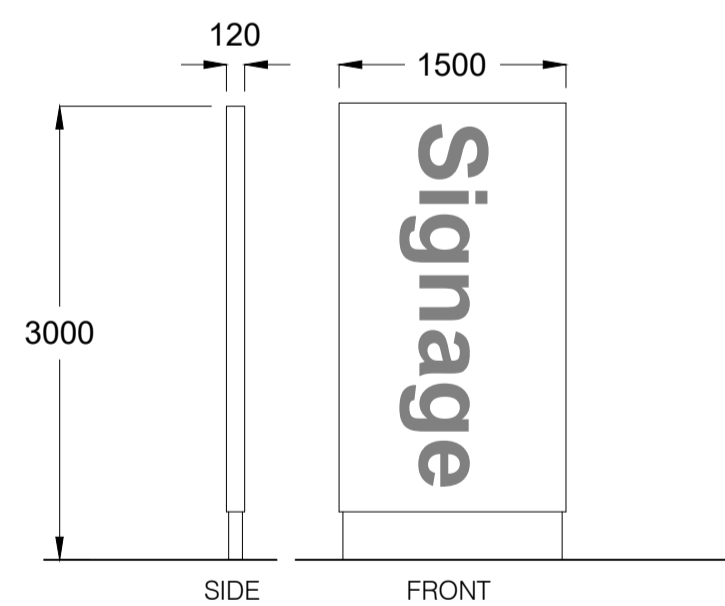

SIGN TYPE D - 1No. (non-illuminated)

Totem, Monolith Sign - digitally printed graphics applied to powder coated aluminium surface

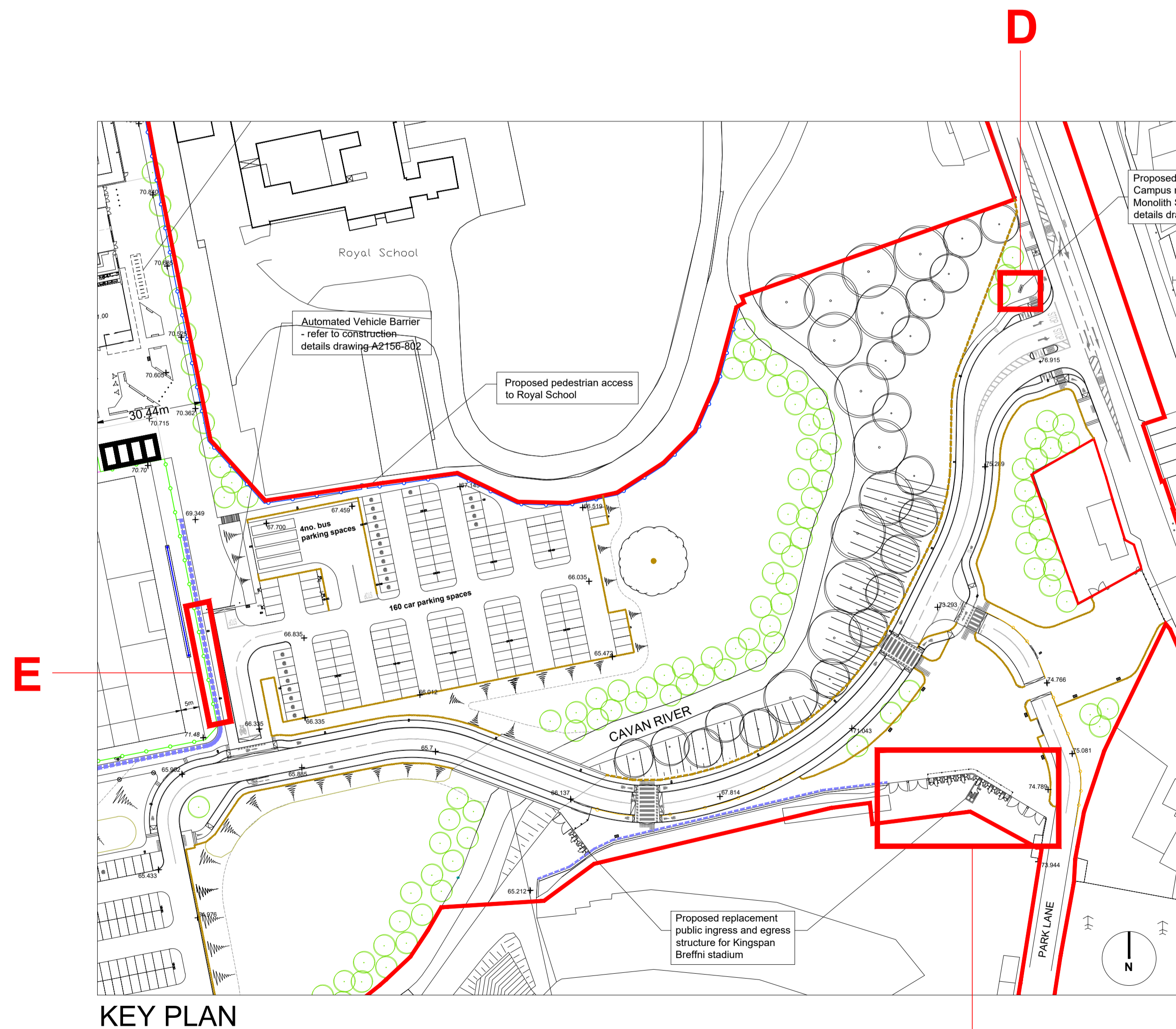

A, B & C
Refer to drawing A2156-100-50

Rev	Issue Date	Description	App
Status	PLANNING		
Client	Cavan County Council		
Project	Cavan Regional Sports Campus		
Drawing	Signage Details		
Scale	1:50 @ A1		
Contact Details	1c Montgomery House 478 Castlereagh Road Belfast, BT5 6BQ	T: 028 9040 2000 E: admin@mcadamdesign.co.uk www.mcadamdsgn.co.uk	
Drawn	04/03/24	Checked	04/03/24
Date	moc	Date	pa
Approved	moc	Date	04/03/24
Project Number	A2156	Drawing Number	800-01
Revision	-	Date	-

All dimensions are in metres. Figured dimensions to be taken in preference to scale dimensions. Dimensions to be checked on site. © 2021 McAdam Design Ltd.