

WATERMAIN LEGEND:

EXISTING WATERMAIN PIPE	— EX WM — EX WM — EX WM —
EXISTING WATER METER	Ⓜ
EXISTING HYDRANT	Ⓜ
EXISTING AIR VALVE	Ⓜ
EXISTING SCOUR VALVE	Ⓜ
EXISTING SLUICE VALVE	Ⓜ
PROPOSED 125mm OUTSIDE DIAMETER PE-80 SDR 17 WATERMAIN PIPE	— WM — WM — WM —
PROPOSED WATERMAIN CONNECTION TO PROPOSED BUILDINGS WITH ANCILLARY BOUNDARY BOX	— WM — WM — WM —
PROPOSED HYDRANT	Ⓜ
PROPOSED AIR VALVE	Ⓜ
PROPOSED SLUICE VALVE	Ⓜ

NOTE:

- NO HYDRANTS ARE CLOSER THAN 6m TO A PROPOSED OR EXISTING STRUCTURE. NO PROPERTY WITHIN THIS PROPOSED DEVELOPMENT IS MORE THAN 46m FROM A FIRE HYDRANT.
- NO NEW WATERMAIN WITHIN THE PROPOSED DEVELOPMENT UP TO AND INCLUDING 150mm Ø IS LAID WITHIN 3m OF AN EXISTING OR PROPOSED STRUCTURE.
- ALL WATERMAIN "T" JUNCTIONS HAVE BEEN SHOWN AT 90 DEGREE ANGLES.

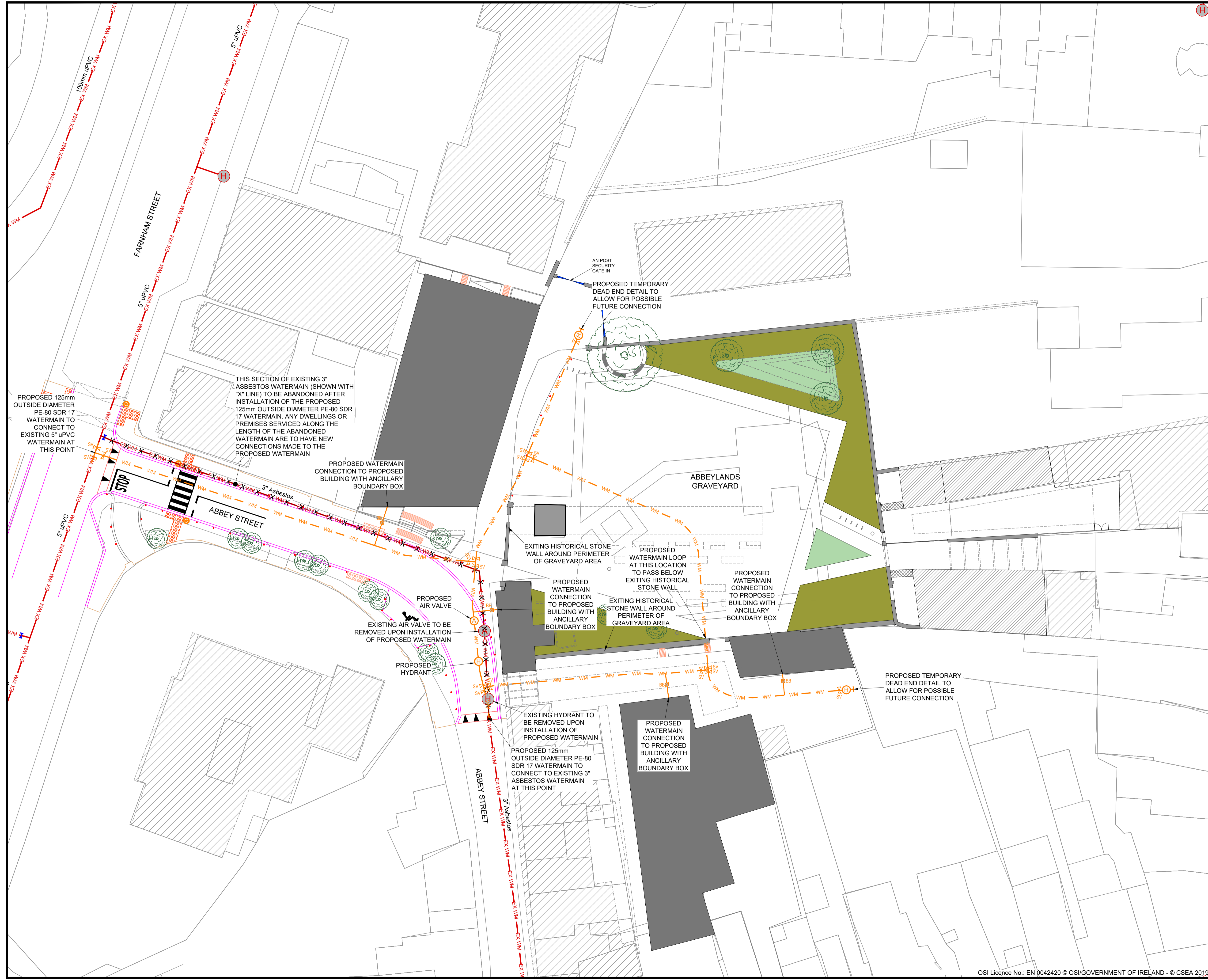
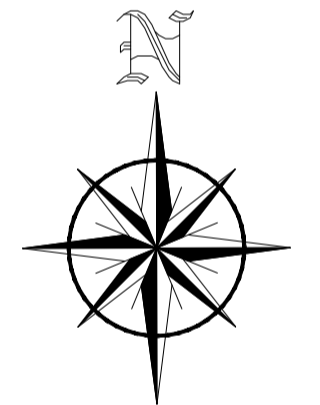

P05	FOR PLANNING	CP	CB	24.11.22
P04	WATERMAIN LAYOUT REVISED	CP	CB	11.11.22
P03	WATERMAIN LAYOUT REVISED	CP	CB	10.11.22
P02	WATERMAIN & LAYOUT UPDATED	CP	CB	09.11.22
P01	FOR DISCUSSION	CP	CB	28.09.22
Rev	Description	Drawn	Checked	Date

Clifton Scannell Emerson Associates Limited
 Consulting Engineers,
 3rd Floor The Highline,
 Bakers Point, Pottery Road,
 Dun Laoghaire, Co. Dublin,
 Ireland, A96 KW29

T: +353 1 288 5006
 F: +353 1 283 3466
 E: info@csea.ie
 W: www.csea.ie

Client	CAVAN COUNTY COUNCIL		
Project	ABBEYLANDS PUBLIC REALM CAVAN DESIGN AND REDEVELOPMENT		
Dwg. Title	PROPOSED WATERMAIN LAYOUT		
Drawn By	CP	Date	28.09.22
Checked By	CB	Scale	1:250 @ A1
Project Code	Originator	Zone/Phase	Level Type Role Dwg. No.
19_134 - CSE - GEN - XX - SK - C - 1012			
S2	FOR PLANNING		
P05	PLANNING		