

- NOTES:**
1. All dimensions are in mm (unless noted otherwise).
  2. This drawing is copyright of Arch-I Modular Solutions Ltd. and may not be altered or reproduced in any form without prior consent.
  3. This drawing is to be read in conjunction with all relevant specifications, drawings and schedules.
  4. P0(n) labelled drawings are 'Preliminary' drafts and are not suited for purpose of construction.
  5. C0(n) labelled drawings are 'Construction' drawings. The details within that sheet have been agreed between parties and are suitable for construction. Yet may be subject to updates, indicated via the revision and number shown (n).
  6. All steelwork manufactured to: BS EN 1090-2 Execution Class EXC2 uno.

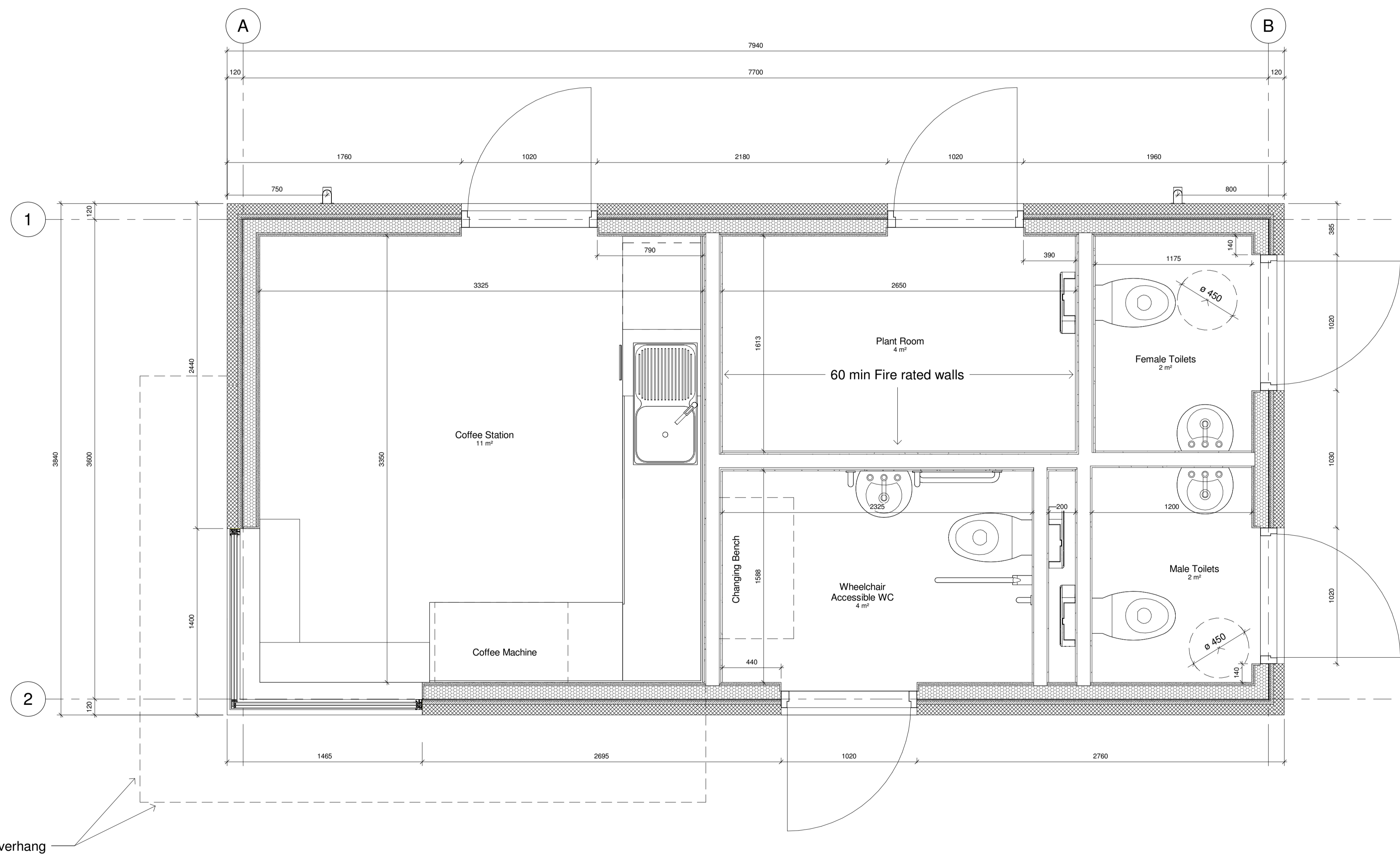

**Floor Plan**  
1 : 20

REVISION	DESCRIPTION	DATE
P01	For Discussion	20.02.2024
P02	For Review	10.05.2024
P03	For Review	22.05.2024
C01	For Construction	07.06.2024
C02	Top Flashing Update	22.07.2024
Z01	As-Built	19.08.2024

**PURPOSE OF ISSUE:** As-Built **DATE:** 19.08.2024

**PROJECT:**  
**Coffee Shop**  
Con Smith Park, Cathedral Road, Cavan, H12 E426

**CLIENT:**  
Cavan County Council

**DRAWING TITLE:**  
Floor Plan and Elevations

**DRAWN BY:**  
Ana Luisa Pedreira

**CHECKED BY:** Sinéad O'Meara **SCALE: (@ A1)** As indicated

**DRAWING NUMBER:** AI24089-ARCHI-DR-A-2010 **REV:** Z01



**Web:** www.arch-i.ie  
**Email:** design@arch-i.ie  
**Address:** Unit A, Lavey Business Park, Cavan, H12 Y660